

# ISC LOW HEAD ROOM

DEDICATED AND NEW PARTS

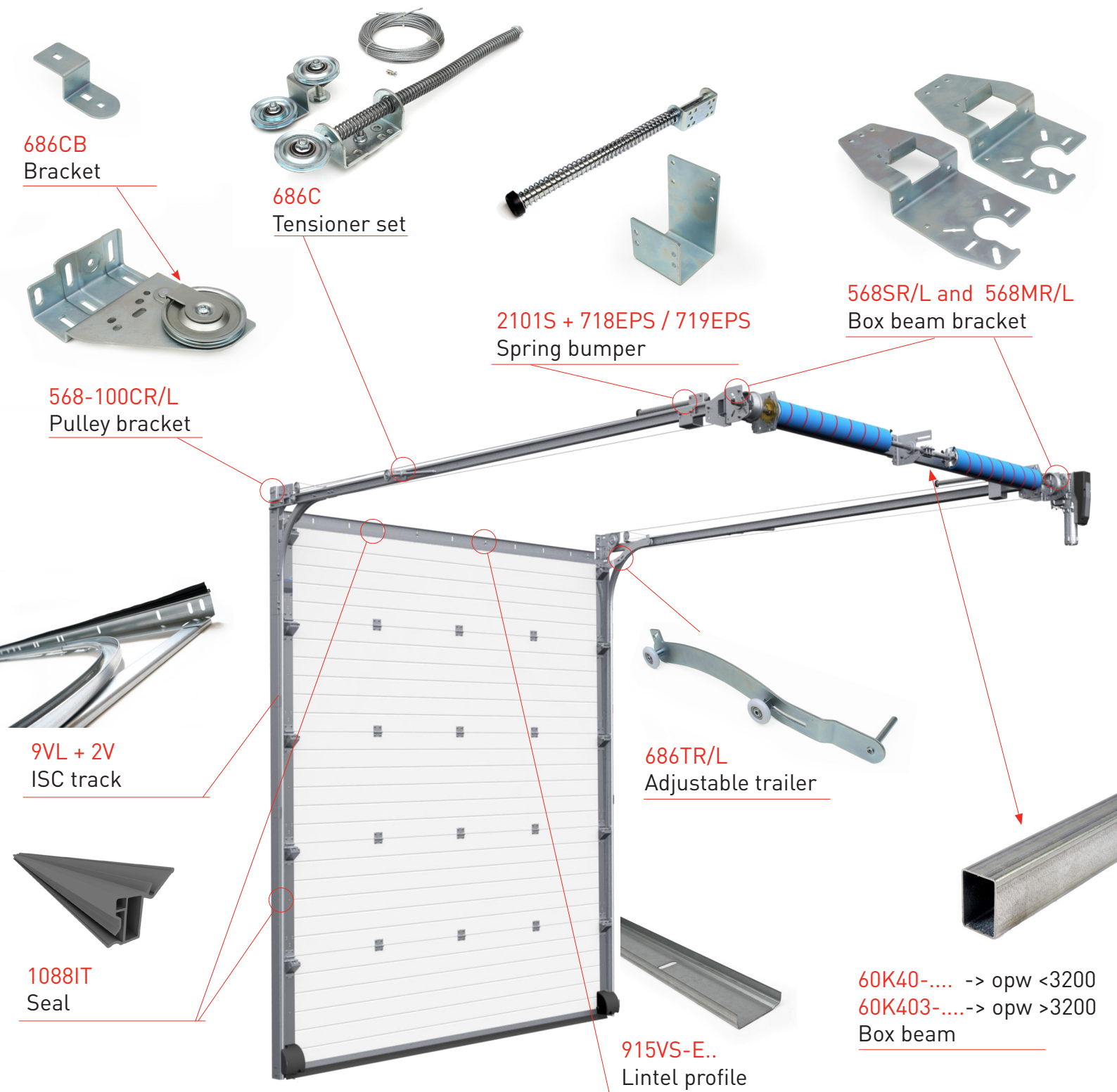

# ISC LOW HEAD ROOM

## MULTIFUNCTIONAL BEARING PLATES 568S/M

---

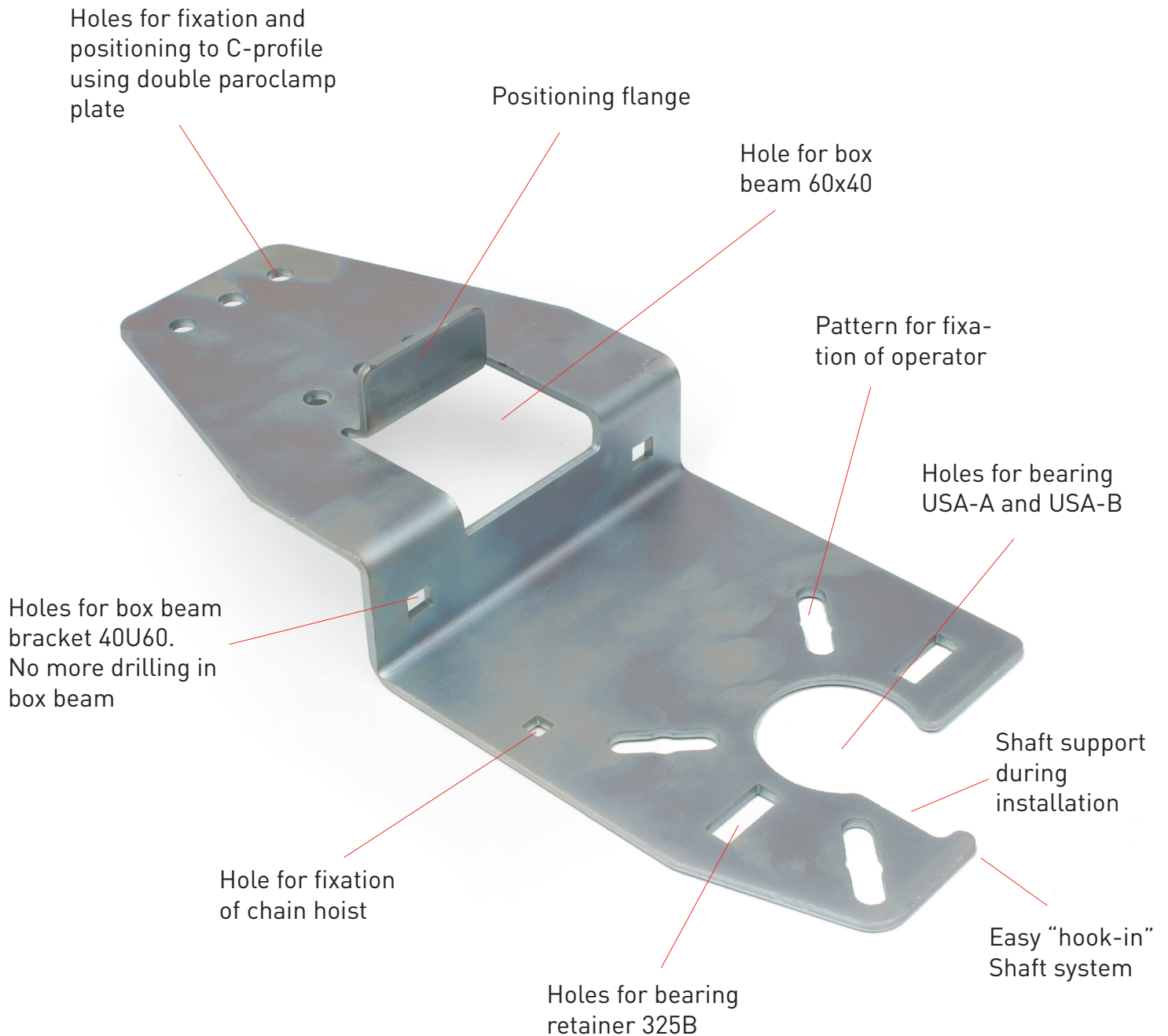

# ISC LOW HEAD ROOM

## MULTIFUNCTIONAL PULLEY BRACKETS 568-100

---

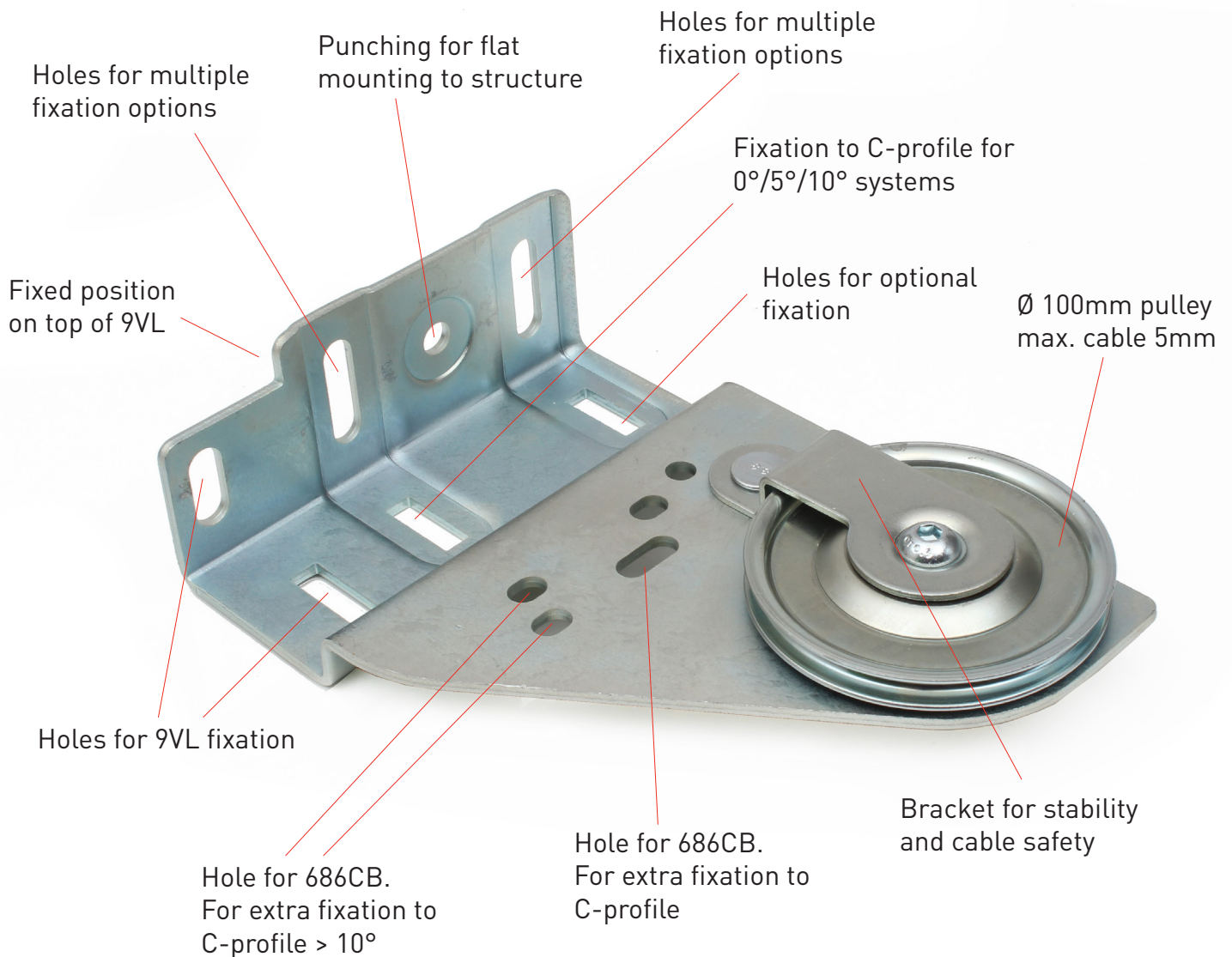

# ISC LOW HEAD ROOM

## MULTIFUNCTIONAL PULLEY BRACKETS 568-100

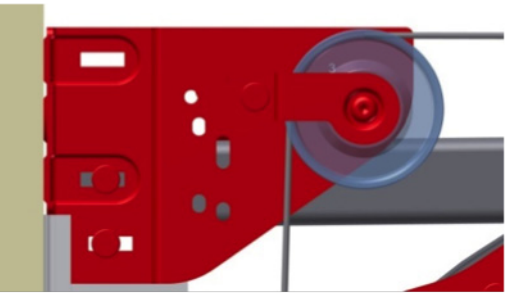

Cable pulley position 1

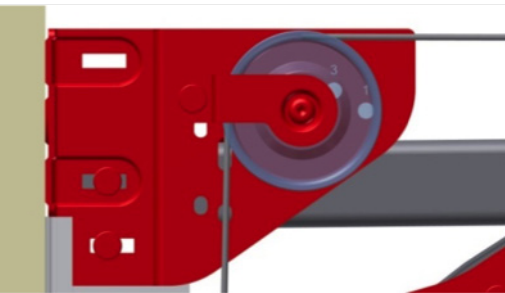

Cable pulley position 2

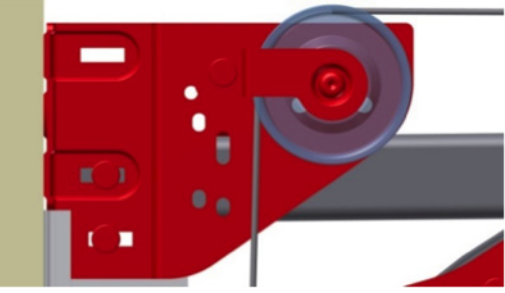

Cable pulley position 3

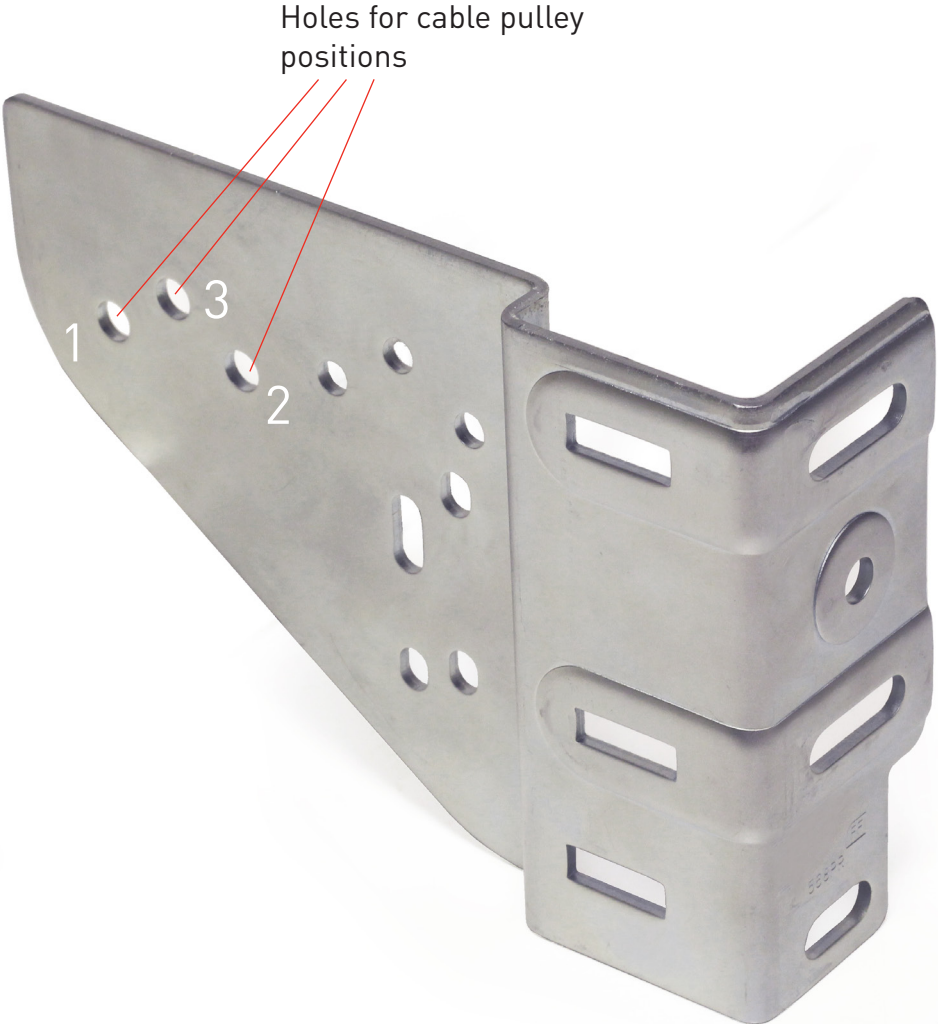

Holes for cable pulley positions

	FFNL12		FFNL18	
	Build-in height	Free opening space	Build in height	Free opening space
Position 1	200mm*	-0mm	225mm*	-0mm
Position 2	200mm**	-10mm	225mm**	-5mm
Position 3	200mm*	-5mm	225mm**	-0mm

The different positions can be used to obtain optimum installation.  
\* cable touches roller shaft.  
\*\* cable free from roller shaft.



# ISC LOW HEAD ROOM

## CABLE TENSION SET 686C

---

